

NV4

Type needle valves with hard seat are designed for use on applications requiring complete isolation or throttling of the media. The conical metal tip (Stem Type CT) press fitted ensures perfect alignment for positive bubble tight shut-off. Available with end connections in sizes from 1/8" to 1" and a wide choice in connections of female screwed, male screwed, male to female screwed or socket weld.

Technical specifications

Design Pressure	:	6000 PSI
Max temp.	:	240°C
Material	:	Stainless Steel
Stem	:	(Type CT) Conical tip press fitted hard chrome plated
Gland Packing	:	PTFE
Stem packing area	:	Burnished finish for Smooth valve operation.
Safety Feature	:	Back seating for preventing stem blowout.



Size	Type	Length A	Width B	Height open) Max., C	Handle D	Handle OD E
1/8"	FxF	50	22	55	40	10
	MxF	55	22	55	40	10
	MxM	60	22	55	40	10
1/4"	FxF	55	25	65	40	10
	MxF	65	25	65	40	10
	MxM	60	25	65	40	10
3/8"	FxF	55	25	65	40	10
	MxF	65	25	65	40	10
	MxM	65	25	65	40	10
1/2"	FxF	65	32	86.6	50	12
	MxF	75	32	86.6	50	12
	MxM	70	32	86.6	50	12
3/4"	FxF	70	38	88.6	50	12
	MxF	75	38	88.6	50	12
	MxM	80	38	86.6	50	12
1"	FxF	90	45	98	70	12
	MxF	105	45	98	70	12
	MxM	105	45	98	70	12

All dimensions are in mm

Applications

- High pressure line shut off.
- Instrument isolation.
- Drain valve.
- Liquid and vapor service.

Optional : NV 10 - High pressure valves for 10,000 psi pressure
NV 20 - High pressure valves for 20,000 psi pressure

Note : Other combination sizes available on request. Please contact factory for more details.

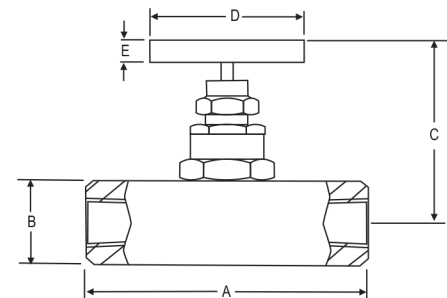

Type FF

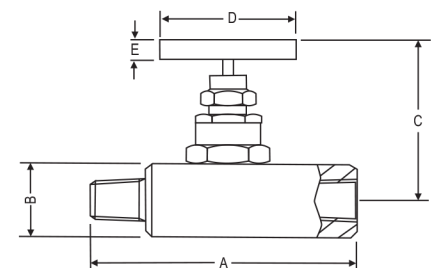

Type MF

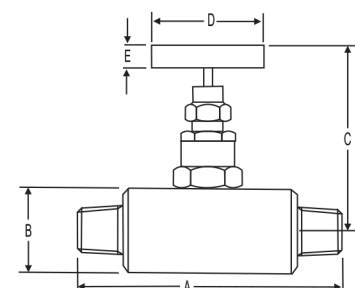

Type MM